

**UNAFLEX MATCHLESS BELLOWS EXPANSION JOINTS
SHORT STYLE SPECIFICATION CHART FOR
STYLE 55**

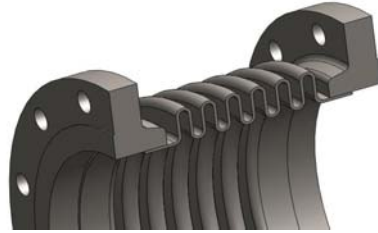

**Style 55 (Fixed 150# RFSO Flanges)
SHP series have 300# RFSO Flanges**

Nominal Size (in.)	Series	Pressure (psig.)	O.A.L. (in.)	Weight (lbs.)	Non-concurrent Movements (in.)			Spring Rates (lbs./in.)	
					Compression	Extension	Lateral	Axial	Lateral
2	SLP	50	6	11	0.64	0.16	0.1	681	945
	SMP	150	6	11				681	945
	SHP	300	6	15				681	945
2.5	SLP	50	6	15	0.64	0.16	0.1	664	1,304
	SMP	150	6	15				664	1,304
	SHP	300	6.5	21				1,253	2,469
3	SLP	50	6	17	0.64	0.16	0.1	703	1,962
	SMP	150	6	17				703	1,962
	SHP	300	7	27				1,343	3,760
3.5	SLP	50	6	23	0.64	0.16	0.1	728	2,132
	SMP	150	6	23				728	2,132
	SHP	300	7	35				1,342	3,938
4	SLP	50	7	27	0.64	0.16	0.1	756	2,740
	SMP	150	7	27				756	2,740
	SHP	300	7.5	45				1,410	5,118
5	SLP	50	8	31	1.04	0.26	0.1	564	3,088
	SMP	150	8	31				581	2,328
	SHP	300	8	58				2,150	10,931
6	SLP	50	8	40	1.04	0.26	0.2	337	1,973
	SMP	150	8	40				744	3,975
	SHP	300	9	81				2,846	14,368
8	SLP	50	9	63	1.28	0.32	0.2	250	1,307
	SMP	150	9.5	64				901	4,720
	SHP	300	11	123				2,833	14,893
10	SLP	50	9.5	89	1.28	0.32	0.2	397	3,273
	SMP	150	9.5	91				1,346	11,120
	SHP	300	11	169				4,119	34,129
12	SLP	50	10	132	1.28	0.32	0.1	309	3,075
	SMP	150	10	134				1,534	14,342
	SHP	300	12	242				7,148	62,597
14	SLP	50	10.5	184	1.28	0.32	0.1	356	4,181
	SMP	150	10.5	189				1,899	20,721
	SHP	300	12.5	348				3,797	41,651
16	SLP	50	11	202	1.28	0.32	0.1	651	9,449
	SMP	150	11	206				2,452	35,626
	SHP	300	13	400				4,887	59,981
18	SLP	50	12	267	1.44	0.36	0.1	559	10,229
	SMP	150	12	272				2,380	43,365
	SHP	300	14	524				4,721	72,641
20	SLP	50	12	342	1.44	0.36	0.1	753	17,181
	SMP	150	12	347				2,960	67,035
	SHP	300	14	665				5,818	132,337
22	SLP	50	12	379	1.44	0.36	0.1	599	16,035
	SMP	150	12.5	389				3,248	83,910
	SHP	300	14.5	779				6,380	139,690
24	SLP	50	13	455	1.44	0.36	0.1	898	28,938
	SMP	150	13	461				3,544	108,343
	SHP	300	15	992				6,958	180,225