

**UNAFLEX MATCHLESS BELLOWS EXPANSION JOINTS
SHORT STYLE SPECIFICATION CHART FOR
STYLE 22**

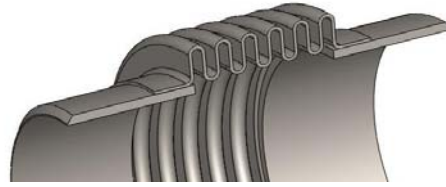

Nominal Size (in.)	Series	Pressure (psig.)	O.A.L. (in.)	Weight (lbs.)	Non-concurrent Movements (in.)			Spring Rates (lbs./in.)	
					Compression	Extension	Lateral	Axial	Lateral
2	SLP	50	6	2	0.64	0.16	0.1	681	945
	SMP	150		4				681	945
	SHP	300		4				681	945
2.5	SLP	50	7	3	0.64	0.16	0.1	664	1,304
	SMP	150		3				664	1,304
	SHP	300		3				1,253	2,469
3	SLP	50	9	4	0.64	0.16	0.1	703	1,962
	SMP	150		4				703	1,962
	SHP	300		4				1,343	3,760
3.5	SLP	50	9	4	0.64	0.16	0.1	728	2,132
	SMP	150		4				728	2,132
	SHP	300		4				1,342	3,938
4	SLP	50	9	5	0.64	0.16	0.1	756	2,740
	SMP	150		5				756	2,740
	SHP	300		5				1,410	5,118
5	SLP	50	10	7	1.04	0.26	0.1	564	3,088
	SMP	150		7				581	2,328
	SHP	300		8				2,150	10,931
6	SLP	50	10	9	1.04	0.26	0.2	337	1,973
	SMP	150		9			0.1	744	3,975
	SHP	300		10			0.1	2,846	14,368
8	SLP	50	10	9	1.28	0.32	0.2	250	1,307
	SMP	150		10			0.1	901	4,720
	SHP	300		12			0.1	2,833	14,893
10	SLP	50	10	12	1.28	0.32	0.2	397	3,273
	SMP	150		14			0.1	1,346	11,120
	SHP	300		15			0.1	4,119	34,129
12	SLP	50	10	15	1.28	0.32	0.1	309	3,075
	SMP	150		17			1,534	14,342	
	SHP	300		22			7,148	62,597	
14	SLP	50	12	18	1.28	0.32	0.1	356	4,181
	SMP	150		23				1,899	20,721
	SHP	300		31				3,797	41,651
16	SLP	50	12	22	1.28	0.32	0.1	651	9,449
	SMP	150		26				2,452	35,626
	SHP	300		34				4,887	59,981
18	SLP	50	12	25	1.44	0.36	0.1	559	10,229
	SMP	150		30				2,380	43,365
	SHP	300		40				4,721	72,641
20	SLP	50	14	41	1.44	0.36	0.1	753	17,181
	SMP	150		46				2,960	67,035
	SHP	300		61				5,818	132,337
22	SLP	50	14	41	1.44	0.36	0.1	599	16,035
	SMP	150		51				3,248	83,910
	SHP	300		68				6,380	139,690
24	SLP	50	14	50	1.44	0.36	0.1	898	28,938
	SMP	150		55				3,544	108,343
	SHP	300		74				6,958	180,225
30	DS	50	14	56	1.44	0.36	0.2	960	175,000
36				67				1,100	248,000
40				72				1,490	380,000
42	DS	50	14	84	1.60	0.40	0.2	1,680	410,000
46				98				1,742	470,000
48				170				3,600	500,000
50	DS	25	14	179	1.60	0.40	0.2	2,500	174,900
52				210				3,215	318,000
54				218				3,605	604,000
60	DS	25	14	242	1.60	0.40	0.1	4,200	780,000
66				283				4,400	1,300,500
72				309				4,750	2,800,300
84	DS	15	14	395	1.60	0.40	0.1	5,478	4,610,000
96				460				6,300	12,100,000
108				491				7,210	18,400,000
126	DS	15	14	565	1.60	0.40	0.08	8,005	19,500,000
132				600				8,715	21,000,500
144				660				9,430	25,000,100