

**UNAFLEX MATCHLESS BELLOWS EXPANSION JOINTS  
SHORT STYLE SPECIFICATION CHART FOR  
STYLES 44 AND STYLE 66**

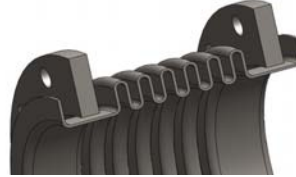

**Style 44 (Fixed 150# Plate Flanges)**



**Style 66 (Vanstone 150# Plate Flanges)**

Nominal Size (in.)	Series	Pressure (psig.)	O.A.L. (in.)	Weight (lbs.)	Non-concurrent Movements (in.)			Spring Rates (lbs./in.)		
					Compression	Extension	Lateral	Axial	Lateral	
2	SLP	50	6	10	0.64	0.16	0.1	681	945	
	SMP	150		10				681	945	
	SHP	300		10				681	945	
2.5	SLP	50	6	13	0.64	0.16	0.1	664	1,304	
	SMP	150		13				664	1,304	
	SHP	300		13				1,253	2,469	
3	SLP	50	6	13	0.64	0.16	0.1	703	1,962	
	SMP	150		13				703	1,962	
	SHP	300		13				1,343	3,760	
3.5	SLP	50	6	20	0.64	0.16	0.1	728	2,132	
	SMP	150		20				728	2,132	
	SHP	300		20				1,342	3,938	
4	SLP	50	7	18	0.64	0.16	0.1	756	2,740	
	SMP	150		18				756	2,740	
	SHP	300		18				1,410	5,118	
5	SLP	50	8	21	1.04	0.26	0.1	564	3,088	
	SMP	150		21				581	2,328	
	SHP	300		22				2,150	10,931	
6	SLP	50	8	26	1.04	0.26	0.2	337	1,973	
	SMP	150		26				0.1	744	3,975
	SHP	300		27				0.1	2,846	14,368
8	SLP	50	8	46	1.28	0.32	0.2	250	1,307	
	SMP	150		37				0.1	901	4,720
	SHP	300		40				0.1	2,833	14,893
10	SLP	50	8	46	1.28	0.32	0.2	397	3,273	
	SMP	150		48				0.1	1,346	11,120
	SHP	300		50				0.1	4,119	34,129
12	SLP	50	9	76	1.28	0.32	0.1	309	3,075	
	SMP	150		78				1,534	14,342	
	SHP	300		84				7,148	62,597	
14	SLP	50	9	107	1.28	0.32	0.1	356	4,181	
	SMP	150		112				1,899	20,721	
	SHP	300		121				3,797	41,651	
16	SLP	50	9	138	1.28	0.32	0.1	651	9,449	
	SMP	150		142				2,452	35,626	
	SHP	300		152				4,887	59,981	
18	SLP	50	10	149	1.44	0.36	0.1	559	10,229	
	SMP	150		154				2,380	43,365	
	SHP	300		166				4,721	72,641	
20	SLP	50	10	191	1.44	0.36	0.1	753	17,181	
	SMP	150		196				2,960	67,035	
	SHP	300		214				5,818	132,337	
22	SLP	50	10	219	1.44	0.36	0.1	599	16,035	
	SMP	150		229				3,248	83,910	
	SHP	300		249				6,380	139,690	
24	SLP	50	11	265	1.44	0.36	0.1	898	28,938	
	SMP	150		271				3,544	108,343	
	SHP	300		292				6,958	180,225	
30	DS	50	11	377	1.44	0.36	0.2	960	175,000	
				497				1,100	248,000	
				602				1,490	380,000	
42	DS	50	11	641	1.60	0.40	0.2	1,680	410,000	
				750				1,742	470,000	
				810				3,600	500,000	
50	DS	25	11	900	1.60	0.40	0.2	2,500	174,900	
				1,008				3,215	318,000	
				1,061				3,605	604,000	
60	DS	25	11	1,347	1.60	0.40	0.1	4,200	780,000	
				1,591				4,400	1,300,500	
				1,799				4,750	2,800,300	
84	DS	15	11	2,137	1.60	0.40	0.1	5,478	4,610,000	
				3,916				6,300	12,100,000	
				3,200				7,210	18,400,000	
126	DS	15	11	4,400	1.60	0.40	0.08	8,005	19,500,000	
				4,700				8,715	21,000,500	
				5,200				9,430	25,000,100	