

**UNAFLEX MATCHLESS BELLOWS EXPANSION JOINTS
LONG STYLE SPECIFICATION CHART FOR
STYLE 55**

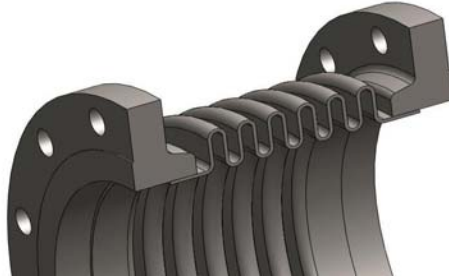

**Style 55 (Fixed 150# RFSO Flanges)
SHP series have 300# RFSO Flanges**

Nominal Size (in.)	Series	Pressure (psig.)	O.A.L. (in.)	Weight (lbs.)	Non-concurrent Movements (in.)			Spring Rates (lbs./in.)	
					Compression	Extension	Lateral	Axial	Lateral
2	LLP	50	8	11	1.60	0.40	0.5	389	180
	LMP	150	8	11			0.3	483	219
	LHP	300	8	15	0.96	0.24	0.3	1,052	471
2.5	LLP	50	10	15	1.60	0.40	0.5	279	105
	LMP	150	10	15			0.3	688	253
	LHP	300	10.5	22	1.20	0.30	0.2	1,403	896
3	LLP	50	9.5	17	1.60	0.40	0.6	312	166
	LMP	150	9.5	18			0.4	721	379
	LHP	300	11	28	1.20	0.30	0.3	1,474	778
3.5	LLP	50	10	23	1.60	0.40	0.6	336	228
	LMP	150	8.5	24			0.4	589	686
	LHP	300	9.5	36	1.28	0.32	0.3	1,209	1,284
4	LLP	50	10	28	1.60	0.40	0.6	378	342
	LMP	150	10	28			0.4	743	671
	LHP	300	11	47	1.28	0.32	0.3	1,564	1,412
5	LLP	50	11	33	2.40	0.60	0.5	242	249
	LMP	150	11.5	34			0.5	922	862
	LHP	300	13	61	1.60	0.40	0.4	1,760	1,601
6	LLP	50	12	41	2.40	0.60	0.75	260	369
	LMP	150	12	43			0.6	762	1,003
	LHP	300	13	87	1.76	0.44	0.45	1,924	2,292
8	LLP	50	13	67	3.20	0.80	0.75	541	951
	LMP	150	13	69			0.55	1,014	1,788
	LHP	300	15	126	2.08	0.52	0.4	1,846	3,240
10	LLP	50	12.5	91	3.20	0.80	0.6	263	856
	LMP	150	12.5	97			0.45	984	3,344
	LHP	300	14	173	2.08	0.52	0.3	2,318	6,826
12	LLP	50	14.5	136	3.20	0.80	0.8	335	1,015
	LMP	150	15	141			0.5	1,144	3,311
	LHP	300	16.5	251	2.08	0.52	0.3	11,532	3,971
14	LLP	50	15	189	2.88	0.72	0.7	359	1,291
	LMP	150	15	195			0.5	1,055	3,850
	LHP	300	16	358			0.4	2,373	8,924
16	LLP	50	15.5	206	2.88	0.72	0.7	362	1,676
	LMP	150	15.5	213			0.4	1,362	6,318
	LHP	300	16.5	411			0.4	3,054	14,233
18	LLP	50	15.5	272	2.88	0.72	0.5	419	2,415
	LMP	150	16	279			0.35	1,588	9,163
	LHP	300	17	537			0.3	3,257	19,258
20	LLP	50	15	342	2.88	0.72	0.4	428	3,761
	LMP	150	15	349			0.3	1,721	14,290
	LHP	300	17	673			0.3	3,134	26,708
22	LLP	50	16.5	387	2.88	0.72	0.6	346	3,068
	LMP	150	17	399			0.25	2,730	24,241
	LHP	300	18.5	793			0.25	6,012	49,988
24	LLP	50	15	460	2.88	0.72	0.2	641	10,432
	LMP	150	15	468			0.2	2,531	38,408
	LHP	300	17.5	1,007			0.2	4,970	75,699